

# **Nomad**

## SERVICE BULLETIN

Reference No.

TRANSMITTAL SHEET FOR NOMAD SERVICE BULLETIN

SERVICE BULLETIN NO: NMD-76-1

DATED: 12th February, 1990

TITLE: Engine Controls - Strengthened Condition Lever Linkage  
(Modification N610)

REVISION NO:

DATE:

ACTION: Insert Service Bulletin NMD-76-1 into Service Bulletin publication and annotate index accordingly.

REASON: A malfunction in the condition lever linkage could permit the pilot to exert excessive shear loads on the tapered pins in the condition lever assembly.

REMARKS:

# Nomad SERVICE BULLETIN

ENGINE CONTROLS - STRENGTHENED CONDITION  
LEVER LINKAGE  
(MODIFICATION N610)

## 1. Planning Information

### A. Effectivity

All Nomad N22 Series and N24 Series aircraft whose log books do not already recorded the embodiment of Mod N610 or compliance with Service Bulletin NMD-76-1.

NOTE: Aircraft serial number N22S-159 to N22S-165 inclusive have this Modification incorporated as basic.

### B. Reason

Should a malfunction occur that causes binding in the condition lever linkage, it is possible for the pilot to exert excessive shear loads on the tapered pins in the condition lever assembly.

### C. Description

The two 3/32 in. dia. tapered pins securing the lever assemblies to the spindle of the condition lever assembly, are replaced by 1/8 in. dia. tapered pins.

### D. Compliance

At Operator's discretion but it is recommended that the Service Bulletin be incorporated as soon as practicable.

### E. Approval

The modification detailed herein has been approved pursuant to CAR35 and conforms with type certification requirements.

### F. Manpower

Three manhours.

### G. Material - Price and Availability

The parts required are to be obtained from Operator's stock or procured from local sources.

### H. Tooling - Price and Availability

None required

Page No	1	2	3
Rev No	-	-	-

I. Weight and Balance

None

J. References

MM - Maintenance Manual Chapters 76-10-00 and 76-10-20  
IPC - Illustrated Parts Catalogue 76-10-00

K. Publications Affected

Maintenance Manual  
Illustrated Part Catalogue

2. Accomplishment Instructions

- A. Remove the condition lever assembly as detailed in MM chapter 76-10-20.
- B. Remove the tapered pin at the top of the condition lever assembly.
- C. Drill and ream condition lever assembly to suit new tapered pin MS24692-104. Carefully drive the tapered pin into the hole and, supporting the larger end of pin, peen the smaller end.
- D. Remove the tapered pin at the bottom of the condition lever assembly and repeat sub-para C. above.
- E. Check that the levers rotate freely before installing the condition lever assembly as shown in Figure 1 and detailed in MM chapter 76-10-20. Fit new lock nuts to the bearing block bolts and to the machine screws for the clevis end and push rod end fittings.

3. Material Information

Parts required per aircraft from Operator's stock.

<u>Part No</u>	<u>Title</u>	<u>No off</u>
MS24692-104	Tapered Pin 1/8 in.dia.x 3/4 in.lg	2
MS21044N3	Nut	2
MS21042-08	Nut	4

4. Special Tools and Equipment

None

# Nomad SERVICE BULLETIN

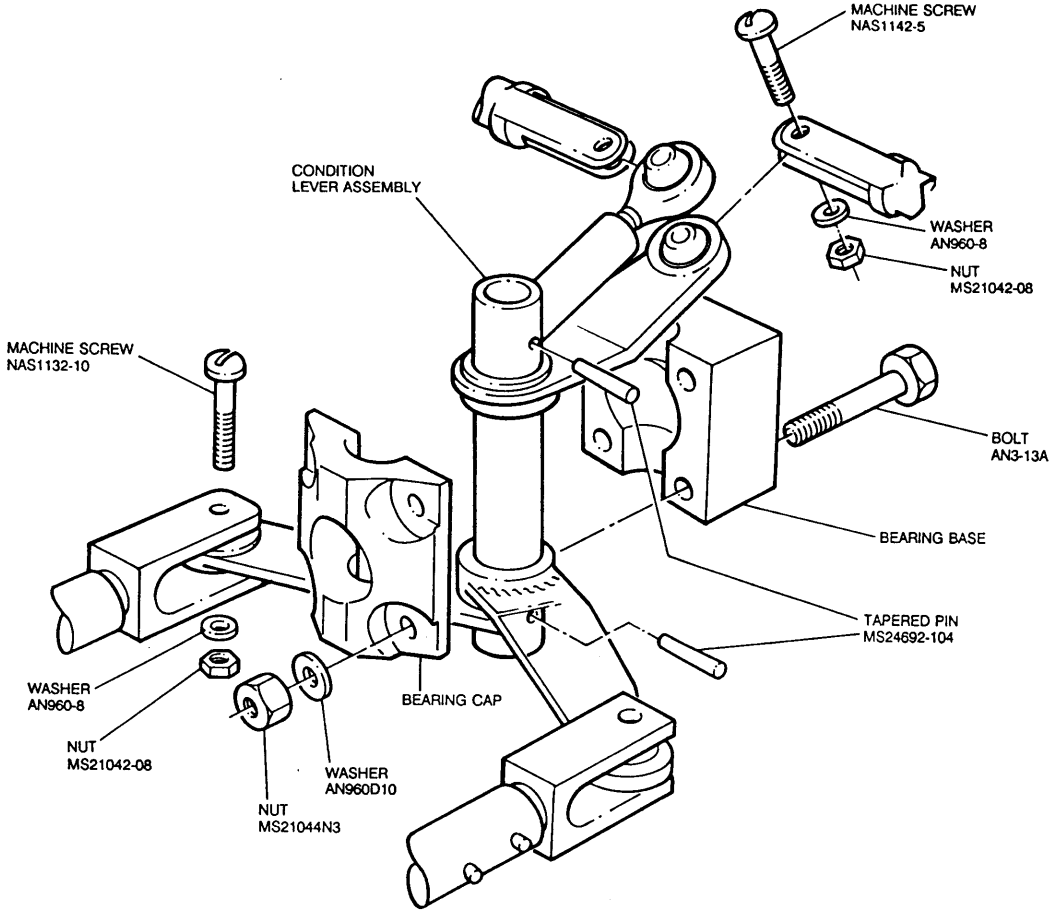

Installation of Condition Lever Assembly  
Figure 1