

Nomad SERVICE BULLETIN

EQUIPMENT AND FURNISHINGS — COCKPIT SUNVISORS NON-MAGNETIC ARM (MOD N720)

1. PLANNING INFORMATION

A. Effectivity

(1) Aircraft Affected

- (a) **N22 Series** line sequence numbers 1 to 9, 11 to 29, 31, 33, 35, 37, 39 to 41, 43, 45, 47 to 59, 61, 63, 65 to 70, 82 to 88, 90 to 95, 97, 100, 102 to 114, 116, 118, 125, 126, 131 to 134, 136 to 138, 141, 143 to 170.
- (b) **N24 Series** line sequence numbers 10, 30, 32, 34, 36, 38, 42, 44, 46, 60, 62, 64, 71 to 81, 89, 96, 98, 99, 101, 115, 117, 119 to 124, 127 to 130, 135, 139, 140, 142.

(2) Spares Affected

Sunvisor Assemblies 1/N-10-800 and 1/N-10-801.

B. Reason

Instances have been found where the sunvisor arms become magnetised which affects the standby compass when the sunvisors are swung from the front to the side.

C. Description

- (1) On all aircraft, the existing cockpit sunvisor arms 1/N-10-802 and 1/N-10-803 are replaced with non-magnetic items PN 2/N-10-802 and 2/N-10-803.
- (2) Removal of existing Standby Compass Warning Placard PN 1/N-00-961 or 1/N-00-962 as appropriate.
- (3) The installation of Standby Compass Warning Placard PN 1/N-00-337.

NOTE

Incorporation of this Service Bulletin supersedes the requirements of SB ANMD-34-5.

D. Compliance

Compliance with this Service Bulletin is RECOMMENDED.

E. Approval

The requirement detailed herein has been approved by a person authorised under Civil Aviation Regulation 35 and conforms to the type certification requirements.

Page No.	1	2	3	4
Revision No.	0	0	0	0

Nomad SERVICE BULLETIN

F. **Manpower**

Three man-hours, plus time taken to conduct a compass swing.

G. **Material – Price and availability**

Contact Boeing Aircraft Systems– ASTA, Customer Spares for price and availability of parts.

H. **Tooling**

None.

I. **Weight and Balance Change**

None.

J. **References**

Maintenance Manual	34–24–00
Illustrated Parts Catalogue	25–10–00, 34–20–00

K. **Publications Affected**

Maintenance Manual	34–24–00
Illustrated Parts Catalogue	25–10–00, 34–20–00

2. **ACCOMPLISHMENT INSTRUCTIONS**

- (1) Remove both RH and LH Sunvisor Assemblies PN 1/N–10–800 and 1/N–10–801 by drilling out five rivets on each pivot plate. Clean up all swarf and rivet tails.
 - (a) Disassemble sunvisor assemblies and discard Tube Assemblies PN 1/N–10–802 and 1/N–10–803. Retain all mounting hardware for re-use, condition permitting.
 - (b) Reassemble sunvisors using new non-magnetic Tube Assemblies 2/N–10–802 and 2/N–10–803.
 - (c) Re-identify Sunvisor Assemblies as PN 2/N–10–800 and 2/N–10–801 respectively.
 - (d) Fit modified sunvisor assemblies to aircraft and rivet in position using PN AGS2050–429BS or equivalent blind fasteners (5 off per sunvisor).
- (2) Remove the existing standby compass warning placard (Ref SB ANMD–34–5).
- (3) Install Warning Placard PN 1/N–00–337 on standby compass placard mounting plate.
- (4) If a placard mounting plate is not existing, remove the compass correction card and card holder from the mounting bracket and manufacture a placard mounting plate as shown in Figure 1. Position the placard mounting plate between the compass card holder and the mounting bracket and rivet in position using two MS20426AD2–4 rivets (Ref Figure 2). Apply the placard to the placard mounting plate and refit the compass card.
- (5) Perform compass swing as per MM Chap 34–24–00.

Nomad SERVICE BULLETIN

3. MATERIAL INFORMATION

- (1) The following parts are required for each aircraft from Boeing Aircraft Systems– ASTA, Customer Spares.

New Part No	Qty	Description	Old Part No	Instruction/Disposition
2/N-10-802	1	Tube Assembly RHS	1/N-10-802	Discard
2/N-10-803	1	Tube Assembly LHS	1/N-10-803	Discard
1/N-00-337	1	Placard	1/N-00-961	Discard
			1/N-00-962	Discard
AGS2050-429BS or CR3523P-4-05	10	Rivet – Blind		
MS20426AD2-4	2	Rivet		

4. SPECIAL TOOLS AND EQUIPMENT

None.

5. RECORDING ACTION

Record compliance with Service Bulletin NMD-25-7 in the Airframe Log Book.

Nomad SERVICE BULLETIN

NOTE: ALL DIMENSIONS IN INCHES UNLESS OTHERWISE STATED.

MATERIAL: 0.020 IN THICK AL ALLOY
2024-T4-3 ALCLAD
QQ-A-250/5
FINISH: PRIME AND PAINT MATT
BLACK.

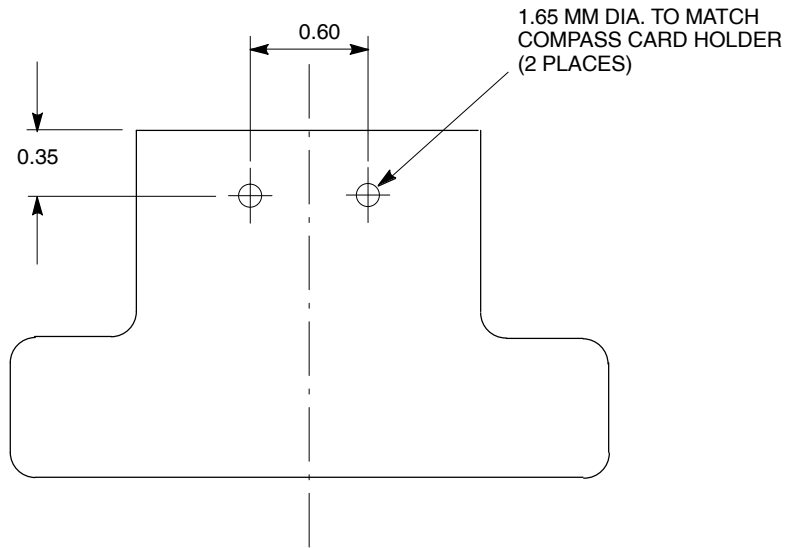

Figure 1 Placard Mounting Plate Pattern

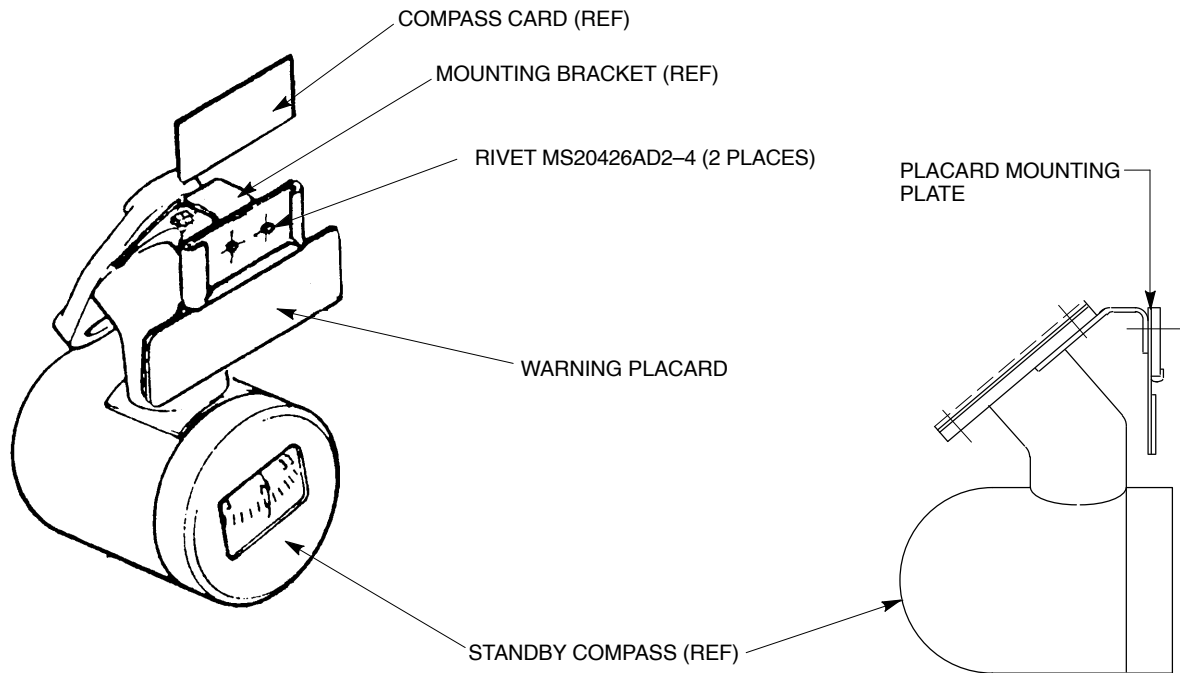

Figure 2 Placard Mounting Plate Installation